

# Patio Doors



Built to Protect Year After Year



# TABLE OF CONTENTS

## CUSTOM OPTIONS

MP Doors has over 25 combined years of creative design, research, and development. We manufacture every component of our doors to ensure the highest quality goes into each and every step of production.







## Explore your Options with MP Doors

Designed with style and durability in mind, MP Doors offers a complete line of patio doors.

Explore MP Doors and explore the possibilities for your home. MP Doors offers the options you want and need, from coastal living solutions with PG50 and Impact-Rated doors to seamless solutions to accommodate your pet.

Customize your door with energy-efficient glass options and stylish handle sets. MP Doors are designed to enhance your home and provide the durability to withstand daily use.



# INDEX

## Masterpiece Series

Gliding Doors	3
Hinged Doors	5

## Shaker Series

Gliding Doors	7
Hinged Doors	9
Pet Door Option	11

## Neulite Series Hinged

Impact Rated Hinged Doors	13
---------------------------	----

## Heritage Series

Hinged Doors	15
--------------	----

## Door Options

17
----



The Masterpiece Series Gliding Patio Door featuring Argon insulated LoE tempered glass, is made of durable, waterproof and weather resistant composite material that will not rust or rot. Stainless-steel rollers and track, a satin-nickel handle, keyed lock and auxiliary flush bolt are included. This door is available in a range of styles including LoE blinds between the glass, external grilles and internal grilles between the glass. Every MP Door offers an exceptional look with a lifetime of energy efficiency and performance.

#### Benefits

- Limited Lifetime Warranty
- 100% composite waterproof material will not rust or rot
- High performance Argon insulated LoE tempered glass
- Sloped sill to push water away
- Flush bolt auxiliary lock for security & ventilation
- Adjustable stainless steel rollers and track

#### Panel

- Co-extruded panels come with a smooth white exterior and your choice of smooth white or unstained composite woodgrain interior
- Interlock system with double flexible seal for air tightness
- Adjustable stainless steel tandem rollers provide years of smooth panel operation

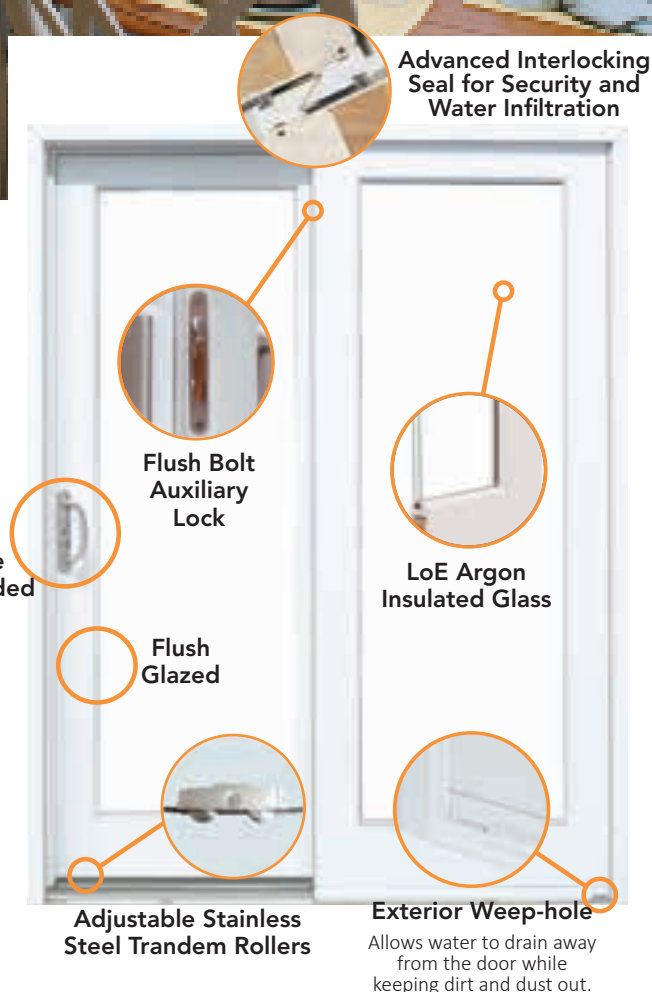







The Masterpiece Series MP Fiberglass Hinged Patio Door has LoE Argon insulated tempered glass. Made of durable, waterproof and weather resistant fiberglass with full composite edging, it will not rust or rot. This door is available in a range of glass styles including LoE blinds between the glass, external grilles and internal grilles between the glass. This door offers a traditional styling with a lifetime of energy efficiency and performance.

**Lifetime  
Limited  
Warranty**

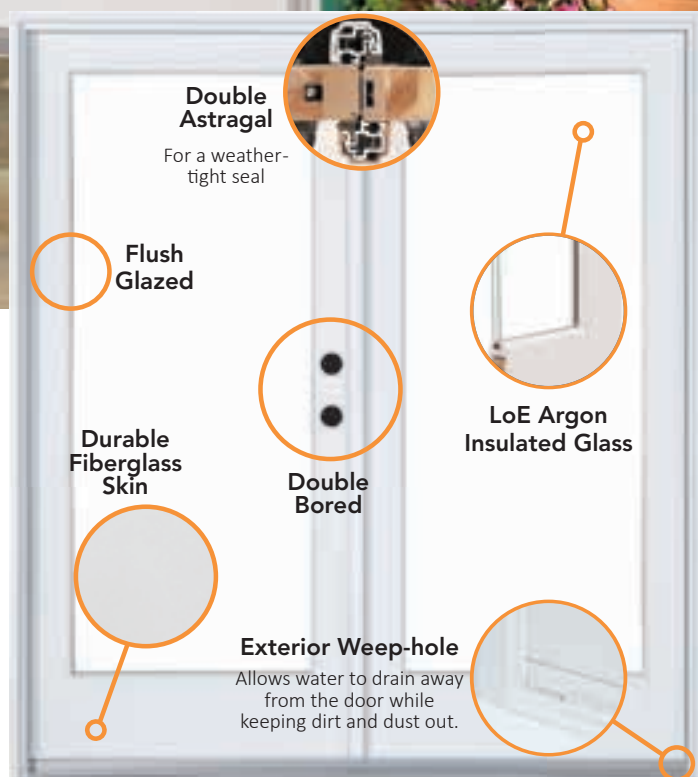

### Benefits

- Waterproof fiberglass will not rust, or rot
- High performance Argon insulated LoE tempered glass
- Sloped sill to push water away

### Panel

- Fiberglass panels have smooth white interior and exterior
- Double bored and ready to receive handleset of your choice

### Frame

- Patented composite frame.
- 4-9/16" standard jamb for 2"X 4" wall construction
- 6-9/16" jamb option available
- Dual weather stripping for air/water seal
- Frames come pre-drilled with plug covers for easier installation

### Ordering Information

- Lead Time 21 Days
- Available in Standard Sizes: 30 in x 80 in, 36 in x 80 in, 60 in x 80 in, 72 in x 80 in

### Features

- Flush Glazed
- Energy Star Certified
- Paintable Finish
- Limited Lifetime Warranty

### Standard Door Options



Smooth White Interior and Exterior

More Information Available on [HomeDepot.com](http://HomeDepot.com)

### Glass Options



Grilles Between Glass (GBG) Available in 10 and 15 Lite Patterns



1 Lite with LoE Glass



\*Raise, Lower and Tilt Blinds Between the Glass. Available in Clear IG and LoE. (No Argon)



Simulated Divided Lite (SDL- External Grilles) Available in 10 and 15 Lite Patterns

\*\*\*Mini Blind option may not meet energy star requirements.\*\*\*

Exterior View

Rough Opening	30 7/8"	36 7/8"	4'-11 1/2"	5'-11 1/2"
Unit Dim.	30 1/8"	36 1/8"	4'-10 3/4"	5'-10 3/4"
Glass Dim.	20"	26"	20"	26"
<div>6'-8"</div> <div>6'-7 1/2"</div> <div>64"</div>				
	*30" x 80"	*36" x 80"	60" x 80"	72" x 80"
	*30" x 80"	*36" x 80"	60" x 80"	72" x 80"

Left Handing

Right Handing

\*\*\*Available as single stationary unit\*\*\*



MP Doors are precision engineered to provide a door that not only looks beautiful, but is built to last a lifetime. The Shaker Series features 2/3 Glass Lite with a solid bottom panel, for a modern touch on a traditional Shaker style. Featuring weather-proof composite construction, this standard size pre-hung door requires no assembly and easily installs into an existing patio door opening.

Exclusively available for order on [Homedepot.com](https://www.homedepot.com)



Handle  
Set  
Included

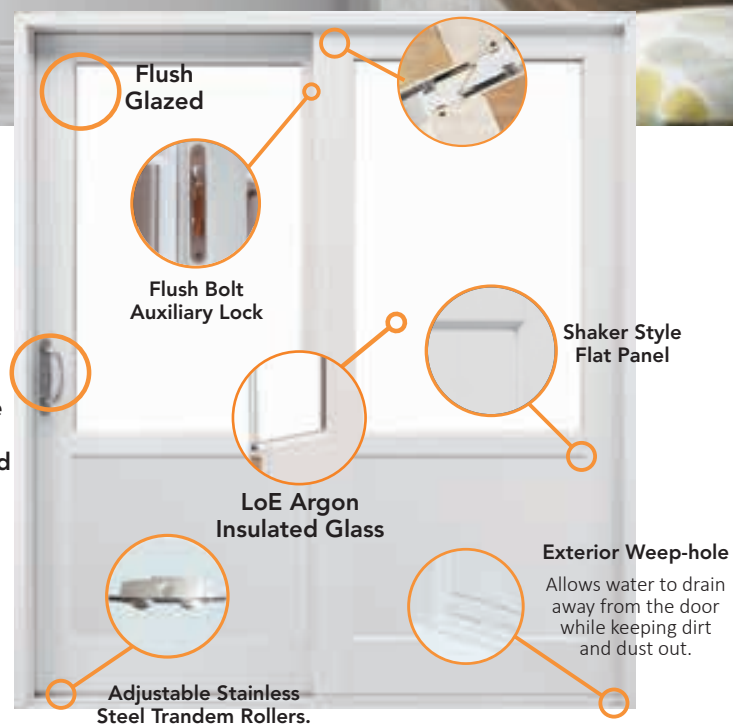



## DOOR SIZE



**GLIDING 60"x80"**

W 59 1/4" x H 79 1/2"



**GLIDING 72"x80"**

W 71 1/4" x H 79 1/2"

## GLASS OPTIONS



Glass: LoE



Glass: LoE miniblinds

### Features and Benefits

- 100% composite waterproof material will not rust or rot
- 5-3/4" full composite jamb with dual weather stripping for 2" x 4" wall construction
- High-performance Argon insulated LoE glass for energy efficiency
- Flush Glazed
- Adjustable stainless steel rollers for smooth door operation
- Interlock system with a double flexible seal for air tightness
- Handleset and flush bolt auxiliary lock included
- Limited Lifetime Warranty for peace of mind
- Energy Star Option
- Pet Door option available

Exterior View

Rough Opening		33 1/4"	39 1/4"	5'	6'
Unit Dim.		32 1/2"	38 1/2"	4'-11 1/4"	5'-11 1/4"
Glass Dim.		21 5/16"	27 5/16"	21 5/16"	27 5/16"

6'-8"

6'-7 1/2"

64"

\*32" x 80"

\*38" x 80"

60" x 80"

72" x 80"

6'-8"

6'-7 1/2"

64"

\*32" x 80"

\*38" x 80"

60" x 80"

72" x 80"

Left Handing

Right Handing

\*\*\*Available as single stationary unit\*\*\*

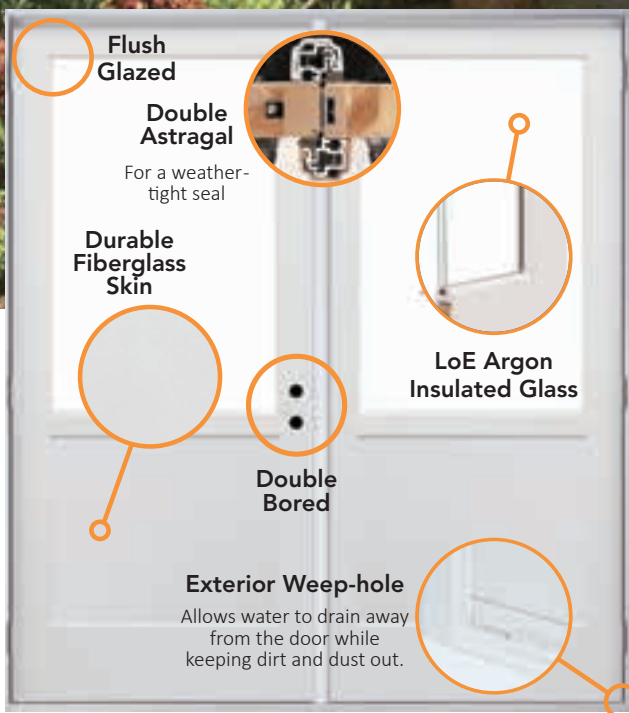

The Shaker Series MP Fiberglass Hinged Patio Door is built to last a lifetime. Made of durable, waterproof, and weather-resistant fiberglass with full-composite edging, it will not rust or rot. This door features 2/3 lite glass lite with a solid bottom panel, for a modern touch on traditional shaker style and is available with a range of options including blinds between the glass and a pet door option. This standard size pre-hung door requires no assembly and easily installs into an existed patio door opening.

Exclusively available for order on [Homedepot.com](https://www.homedepot.com)

**Lifetime  
Limited  
Warranty**

DOOR SIZE



HINGED 60"x80"  
W 58 3/4" x H 79 1/4"



HINGED 72"x80"  
W 70 3/4" x H 79 1/4"

GLASS OPTIONS



Glass: LoE



Glass: LoE miniblinds

Features and Benefits

- Waterproof fiberglass door with full-composite edging will not rust or rot
- 4-9/16" full composite jamb with dual weather stripping for 2" x 4" wall construction
- 6-9/16" jamb option available
- High-performance Argon insulated LoE glass for energy efficiency
- Flush Glazed
- Weatherstripping included for air tightness
- Double bored for handle set of your choice
- Lifetime Warranty for peace of mind
- Energy Star Certified
- Pet Door option available

Exterior View				
Rough Opening	31 7/8"	37 7/8"	4'-11 1/2"	5'-11 1/2"
Unit Dim.	30 1/8"	36 1/8"	4'-10 3/4"	5'-10 3/4"
Glass Dim.	20"	26"	19 3/4"	25 3/4"
6'-7" 6'-7 1/4" 40"				
	*30" x 80"	*36" x 80"	60" x 80"	72" x 80"
6'-7" 6'-7 1/4" 40"				
	*30" x 80"	*36" x 80"	60" x 80"	72" x 80"

\*\*\*Available as single stationary unit\*\*\*





Extra large Pet Door included

The Shaker Series Doors with the optional Pet Door is a pet-friendly addition to your home, offering your beloved pet constant access to outdoor space and refuge indoors. The integrated, double-walled, flexible flap gives your pet the freedom to come and go at their own leisure without barking or scratching at the door. The pet door also comes with a firm lock-out panel that snaps into place to lock the door. Enjoy the full use of your Sliding or Hinged Door with a pet door that flows seamlessly into the design and construction of the door.

## DOOR SIZE



**GLIDING 60"x80"**

W 59 1/4" x H 79 1/2"



**GLIDING 72"x80"**

W 71 1/4" x H 79 1/2"



**HINGED 60"x80"**

W 58 3/4" x H 79 1/4"



**HINGED 72"x80"**

W 70 3/4" x H 79 1/4"

\*Pet Door option does not meet Energy Star requirements.

Exclusively available for order on [Homedepot.com](https://www.homedepot.com)

**Pet Door Size**

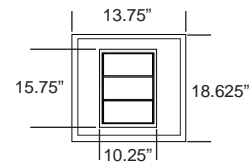

**Lifetime  
Limited  
Warranty**



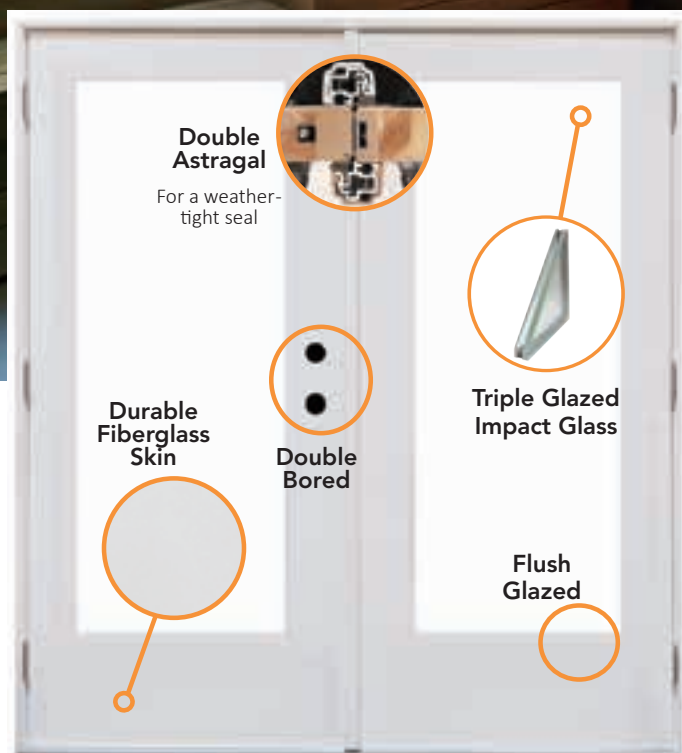

The MP Hinged Neulite Series Patio Door is a Fiberglass door designed specifically for coastal areas with building codes that require impact-resistant doors. This door features LoE triple glazed tempered glass with Argon fill. Made of durable, waterproof and weather-resistant Fiberglass with full-composite edging, this door will not rust or rot. The subtle brushed texture and the square edge glazing beads offer a classic yet modern look. Energy Star certification ensures that you will save year-round on your energy use.

Exclusively available for order on [Homedepot.com](https://www.homedepot.com)



DOOR SIZE



**HINGED 36"x80"**  
W 36 1/8" x H 79 1/2"



**HINGED 72"x80"**  
W 70 3/4" x H 79 1/2"

IMPACT DOOR

MP Impact Rated Doors are built with high-impact fiberglass door panels, 1" triple layer insulated laminated Impact glass and a full composite frame to resist wind, water and flying debris during a windstorm event. This door is certified by the Florida Building Code for use in windstorm areas. Please consult your local building code requirements.



**Performance Grade**  
**Rated - PG50**

**Florida Building Code**  
**Certification**  
FBC# FL-29714

Features and Benefits

- PG50 Impact rated door for coastal applications
- Triple glazed Impact glass for windstorm protection
- Fiberglass door with full-composite edging will not rust or rot
- 4-9/16" full composite jamb with dual weather stripping for 2" x 4" wall construction
- 6-9/16" jamb option available
- High-performance Argon insulated LoE glass for energy efficiency
- Flush Glazed
- Weatherstripping included for air tightness
- Double bored for handle set of your choice
- Lifetime Warranty for peace of mind
- Energy Star Certified

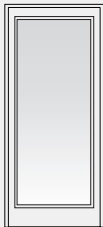
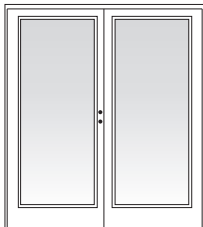
Exterior View

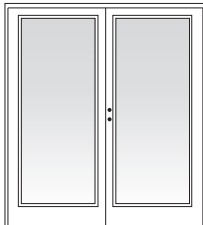
Rough Opening		36 7/8"	5'-11 1/2"	
Unit Dim.		36 1/8"	5'-10 3/4"	
Glass Dim.		22"	22"	
6'-8"	6'-7 1/2"			Left Handing
	64"	*36" x 80"	72" x 80"	
6'-8"	6'-7 1/2"			Right Handing
	64"	*36" x 80"	72" x 80"	

\*\*\*Available as single stationary unit\*\*\*



Impact Designed

Neulite Impact doors are available and tested with all triple glazed laminated glass, and are certified for FBC and FBC-HVHZ.



Reduce Your Energy USE

As part of a energy efficient home, Energy Star certified doors help reduce your energy use.

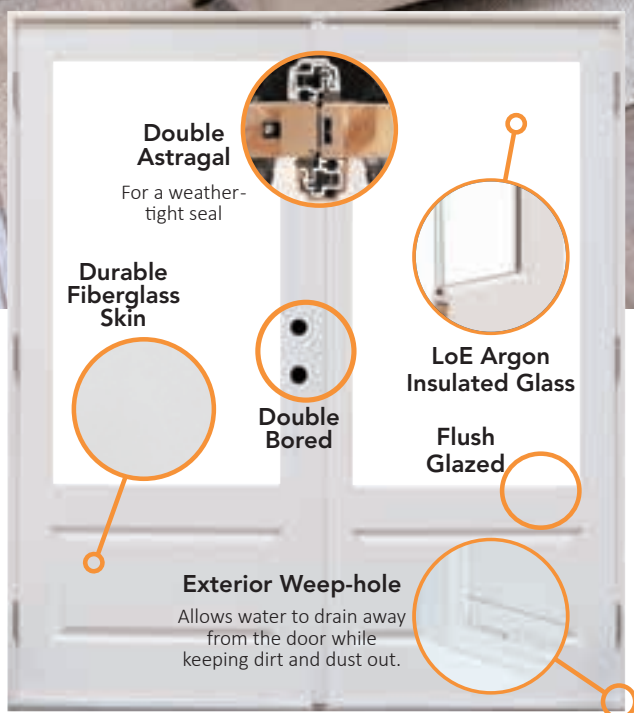

The MP Heritage Series Fiberglass Hinged Patio Door has LoE Argon insulated tempered glass. It is made of durable, waterproof and weather resistant fiberglass with full composite edging, it will not rust or rot. This door is available in a range of glass styles including loE glass with SDL patterns. Achieve a traditional look with a lifetime of energy efficiency and performance with a Heritage Series MP Door.

Exclusively available for order on [Homedepot.com](https://www.homedepot.com)

**Lifetime  
Limited  
Warranty**







### LoE Glass

Argon insulated tempered LoE glass reduces heat flow for energy efficiency



### Blinds Between the Glass

Blinds between the glass feature a cordless tilt, raise and lower operation. The mini blinds are sealed between 2 panes of glass within the door.

### Grilles Between Glass (GBG)

Flat white  $\frac{3}{4}$ " grilles are installed between the two layers of Low-E Argon insulated glass. Grilles between the glass are available in 10 & 15 lite patterns. They create a classic look that allows for easy cleaning while providing excellent energy efficiency.



### Simulated Divided Lites (SDL)

Simulated divided lites give you the classic look and feel of a true divided lite door. Our 100% composite simulated divided lite grills are fixed permanently to both the interior and exterior glass surface, providing higher energy efficiency than individual panes of glass.



## PET DOOR

**Ideal for pets weighing up to 90 lbs. and up to 10 in. wide**

Pet Door Opening Size: **10- $\frac{1}{4}$ " x 15- $\frac{3}{4}$ "**

- The Pet Door features a unique magnetic closure system that enhances wind resistance and ensures a tight seal when the door is not in use.
- Fully integrated, double-walled flexible pet door comes with a rigid lock-out panel to keep out unwanted pests.

Visit [Homedepot.com](http://Homedepot.com) for door and purchase options.



### HANDLE

Satin Nickel handle set comes standard with every door.

\*Brown and White handlesets are optional and available through special order or [homedepot.com](http://homedepot.com)



### SCREEN \*Screens sold separately

The MP Doors 36" Sliding Screen Door is a great addition to any home. The screen is available with a composite frame or metal frame. This screen is reversible. Fiberglass mesh screen provides protection from insects while allowing fresh air and light to flow. A 30" screen is also available to fit all 60" x 80" models.



Fan Lite



4 Lite SDL



Narrow Lite



Craftsman



Full Lite

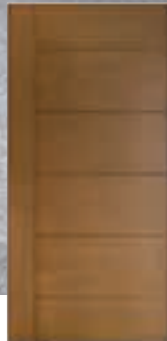

Contemporary Teak



4 Lite



3 Lite



Prestige Oval Lite



3/4 Lite Oval



3/4 Lite



1/2 Lite

Visit [Homedepot.com](https://www.homedepot.com) for our full range of entry doors.

Make a beautiful addition to your home with **MP Doors**.



**Lifetime  
Limited  
Warranty**

**GET IT  
INSTALLED**  
VISIT YOUR LOCAL STORE